

FOR ALL YOUR STORM & SANITARY NEEDS



PH: (239) 482-7468

FX: (239) 482-7469

COASTAL PREGAST  
*of Florida*

P.O. BOX 370  
ESTERO, FL. 33928

## NOTES

### CONCRETE SPECS

4,000 PSI @ 28 DAYS

TYPE II CEMENT

### STANDARDS

EDGED AND BRUSHED FINISH

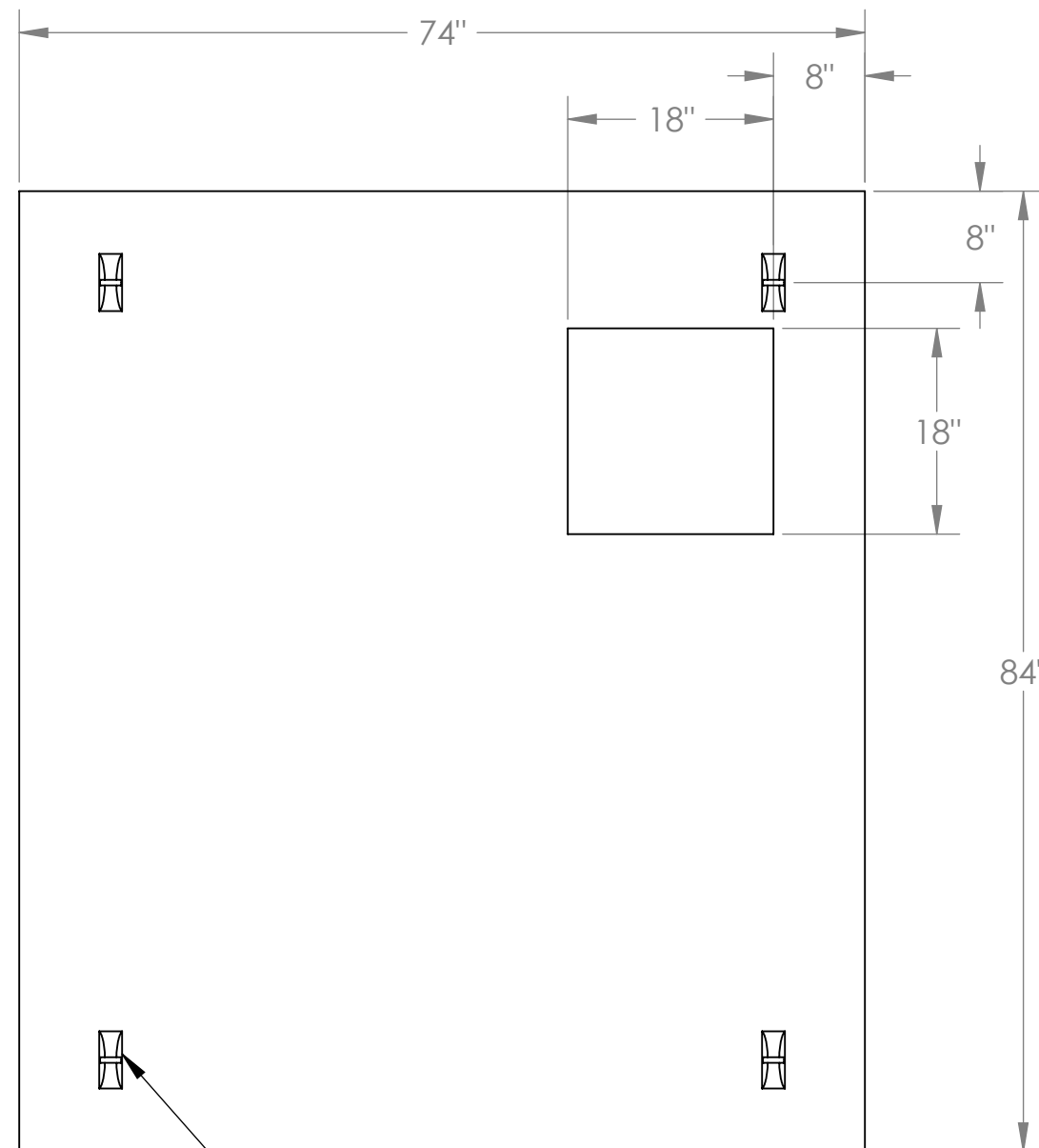

LIFTING  
POINTS

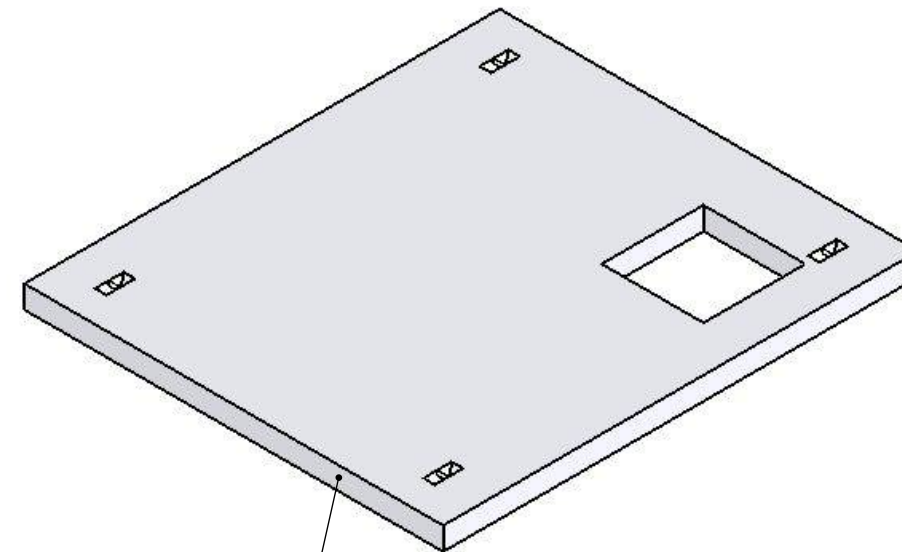

WEIGHT= 1952 LBS.

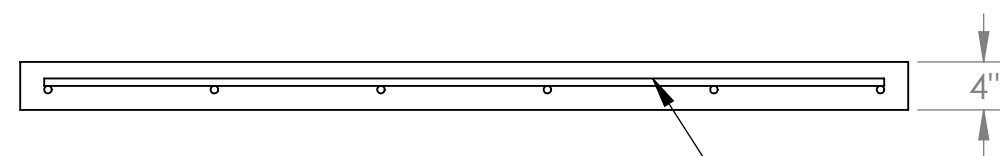

#4 REBAR  
12" OCEW

# 74" X 84" ELECTRIC PAD